

KIT INSTALACAO SUSPENSOR 1/4" TRUCK C/ MANOMETRO
DSR CÓDIGO: 424210

ENGATCAR

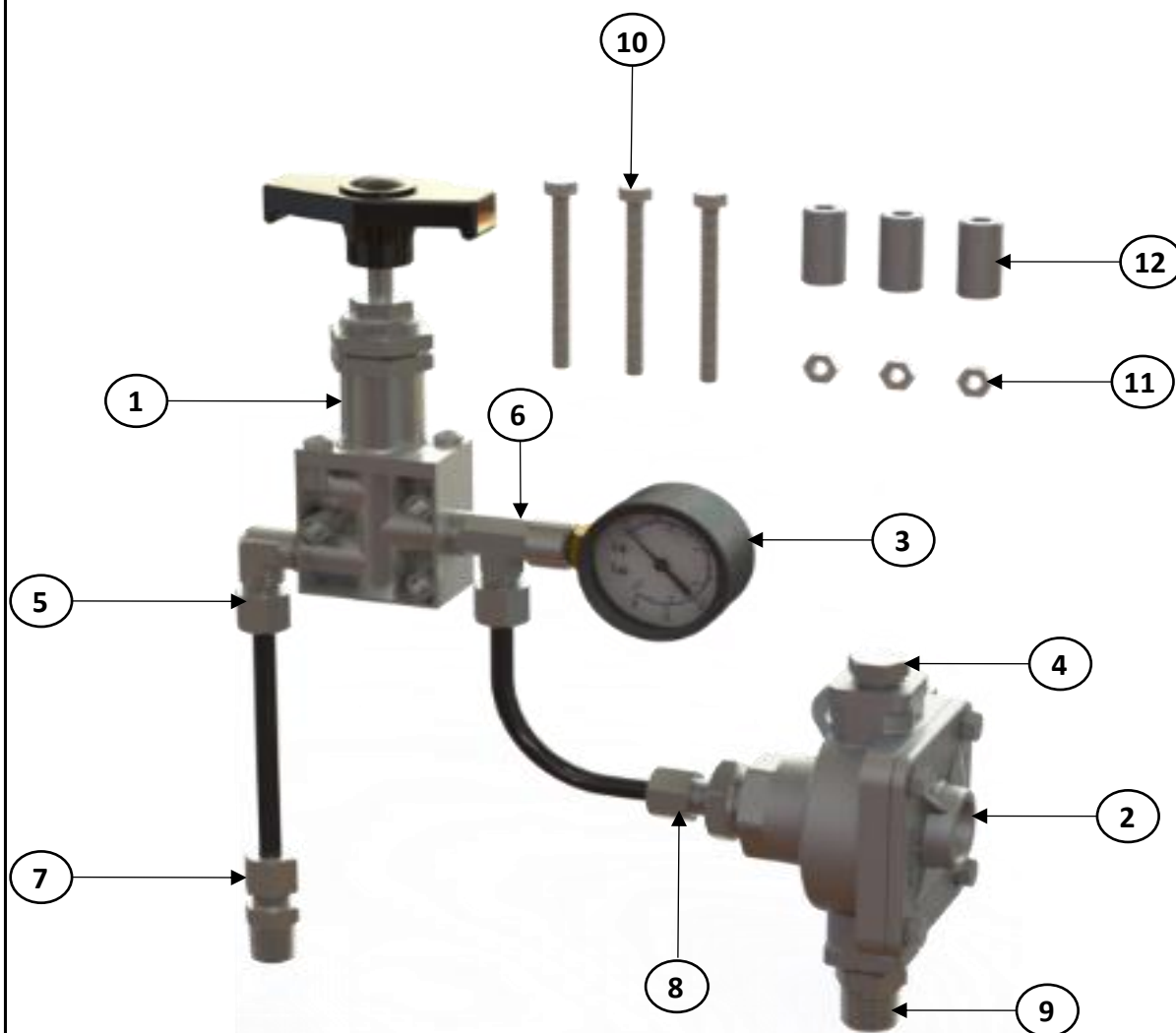

| ITEM | CÓDIGO | DESCRIÇÃO | QUANTIDADE |
|------|--------|--|------------|
| 1 | 001091 | VÁLVULA ACIONAMENTO 1/4 " NPT | 1 |
| 2 | 006001 | VÁLVULA DESCARGA RAPIDA 1/2" X 1/4" NPT | 1 |
| 3 | 415878 | MANÔMETRO 1/8" NPT SAIDA INFERIOR 150 LIBRAS/ Ø 42MM | 1 |
| 4 | 011401 | BUJÃO 1/4" NPT ZK ZA | 1 |
| 5 | 410933 | COTOVELO MAC CP ROSCA 1/4" NPT X TUBO 1/4" ZK | 1 |
| 6 | 415707 | TEE MAC 1/4" NPT X FEMEA 1/8" NPT X TUBO 1/4" ZK | 1 |
| 7 | 411419 | CONECTOR MAC CP ROSCA 1/4" NPT X TUBO 1/4" ZK | 1 |
| 8 | 411420 | CONECTOR MAC CP ROSCA 1/2" NPT X TUBO 1/4" ZK | 1 |
| 9 | 414835 | NIPLE RETO M16 X 1/4" NPT ZB | 1 |
| 10 | 005147 | PARAF SEX RP UNC 3/16" X 2" ZB | 3 |
| 11 | 005258 | PORCA SEXT 3/16" UNC CH 5/16" ZB | 3 |
| 12 | 420502 | BUCHA ESPAÇADORA VALV. ACIONAMENTO | 3 |
| 13 | 010600 | INSERT TUBO 1/4" | 4 |
| 14 | 001061 | TUBO FLEXIVEL NYLON 6,35 (1/4") X 4,35 X 1,00 | 12 m |